



# SPEAKE MARIN

## How to change the new end link on your Ripples?

You need : SMM-001-00192\_ST\_KIT



2x

SMM-001-00192\_ST End link



2x

SMM-111-00073\_ST End link screws



2x

SMM-111-00073\_ST Screws for strap and bracelet

Required tool: a slotted screwdriver 1.8 mm to change the new link for new bracelets.

We can provide this in case you do not have any.  
Reference SMM-400-00012

[www.speake-marin.com](http://www.speake-marin.com)



# 1 How to replace your standard bracelet to a new strap using the new end link kit?

You need:  
End link kit



1 Remove the screws.

Buckle without  
micro-adjustment



3 Take out the screws and the bars on each side  
4 Remove the standard bracelet.



5 Position the new end links.  
6 Secure the end link inserting the screws.



7 Position the new bracelet.  
8 Secure the strap inserting the screws.



9 Tighten the screws.



Damages caused by changing the strap are not covered by the guarantee.

## 2 How to replace your standard bracelet with a new stainless steel 904L bracelet featuring micro-adjustment using the new end link kit?

You need:  
End link kit



1 Remove the screws on the lugs.

Buckle without micro-adjustment



3 Take out the screws and the bars on each side  
4 Remove the standard bracelet.

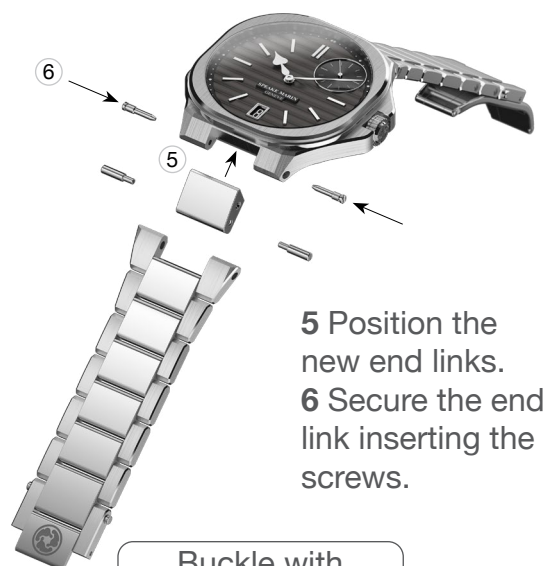

5 Position the new end links.  
6 Secure the end link inserting the screws.

Buckle with micro-adjustment



7 Position the bracelet with micro-adjustment.  
8 Secure the bracelet inserting the screws.



9 Tighten the screws.



Damages caused by changing the strap are not covered by the guarantee.

### 3 How to replace your bracelet to a new strap if you have already a new end link?



1 Remove the screws.

Buckle with  
micro-adjustment

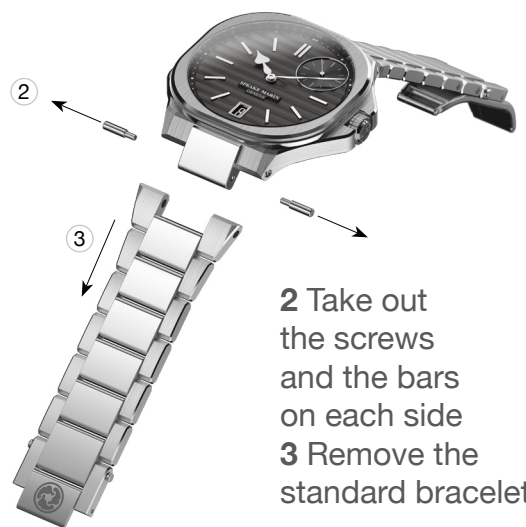

2 Take out  
the screws  
and the bars  
on each side  
3 Remove the  
standard bracelet.

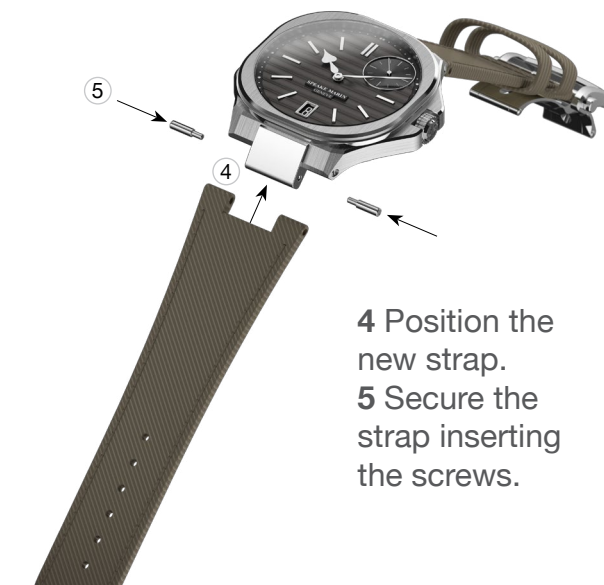

4 Position the  
new strap.  
5 Secure the  
strap inserting  
the screws.



6 Tighten the  
screws.



Damages caused by changing the strap are not covered by the guarantee.

# 4 Bracelets, straps and buckles suitable for the Ripples collection.



**Standard bracelet in 316L stainless steel**  
No micro-adjustment on the folding buckle.  
The end link fixed to the bracelet.



**Bracelet in 904L stainless steel**  
Micro-adjustment on the folding buckle  
The end link fixed to the case.



**Straps collection**  
Suitable with a pin buckle  
or a folding buckle.



Folding buckle  
in titanium



Titanium



Black DLC



Red gold 5N

Pin buckles